

One Story House Cross Section

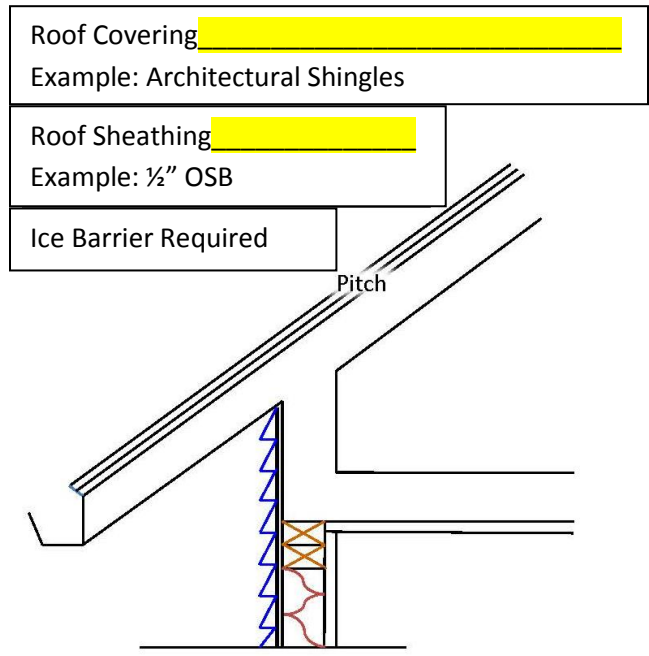

Ridge Board [] X []
Example: 2" X 8" (Larger than cut of rafter)

Collar Tie [] X [] at [] O.C.
Example: 2" X 6" at 48" O.C.

Rafters 2" X [] or Trusses at [] O.C.
Example: Rafters 2" X 8" or at 24" O.

Insulation R- []
Example: R-49

Ceiling Joist 2" X [] at [] O.C.
Example: 2" X 10" at 24" O.C.

Truss/Rafter Tie Down Straps or Fasteners

Wall Sheathing []
Example: 7/16" OSB

Wall Studs 2" X [] at [] O.C.
Example: 2" X 6" at 16" O.C.

Wall Insulation R- []
Example: R-20

Floor Joist Size & Type of Wood []
Example: 2" X 10" SYP #2, I-Joists, Truss Joists

Door and Window Headers

Size and Material []

Overhead Door Header

Size []

Material []

Span []

Siding Material []

Wall Height [] ft

Subfloor []
Example: 3/4" T&G OSB

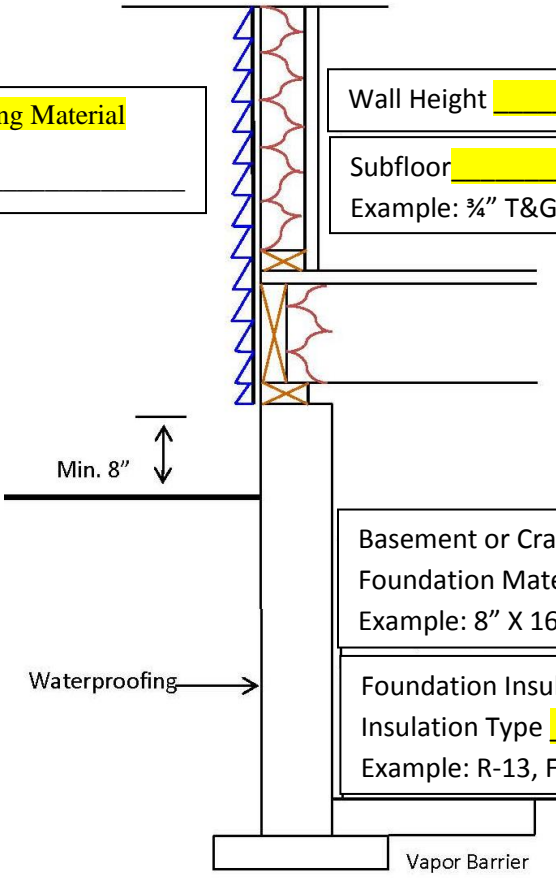

Basement or Crawl Space Height []

Foundation Material []
Example: 8" X 16" concrete blocks, 8" poured walls

Foundation Insulation R- []

Insulation Type []
Example: R-13, Fiberglass batts in framed cavities

Footing Width []

Footing Thickness []

Is the house on a crawl space? YES NO

Is the crawl space heated or vented? YES NO

If vented, the floor joists insulation is R- []

Is there a Radon Depressurization System?
YES NO